



14 MONTPELIER ROAD BRIGHTON, BN1 2LQ

£1,450 PER MONTH

Superb one bedroom garden flat in central Brighton. This bright and spacious ground floor apartment has been neutrally decorated throughout, comprising; bay fronted bedroom, modern bathroom, living room and kitchen with appliances included. Outside you have a private, low maintenance west facing garden. The property further benefits from partial furnishings including; bed, wardrobe, sofa and kitchen 'white goods'.

Conveniently situated on Montpelier Road you have the whole of Brighton easily accessible to you, Brighton beach is located at the end of your road with Western Road offering plenty of transport opportunities and Brighton Mainline station less than 1 mile away.

Nicholas
James

SALES LETTINGS AUCTIONS

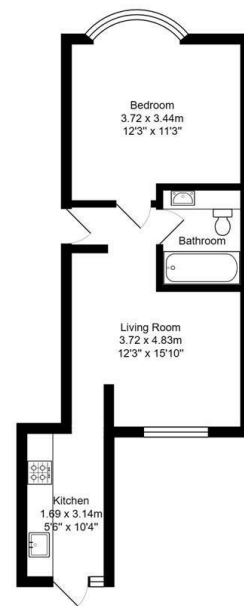
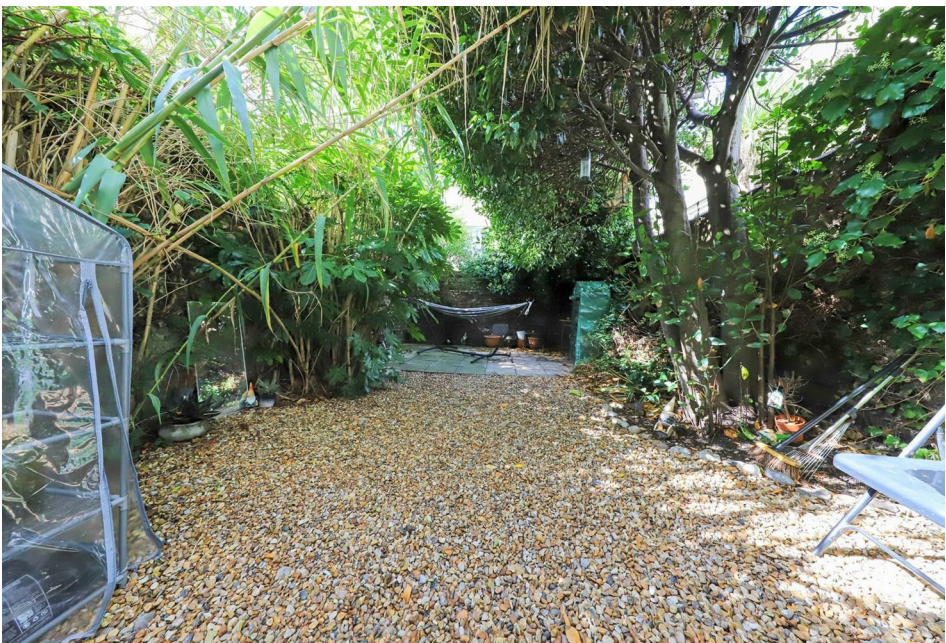

Montpellier Road

Total Area: 40.0 m² ... 430 ft²

All measurements are approximate and for display purposes only.

Energy Efficiency Rating		Current	Potential
Very energy efficient - lower running costs			
(92 plus) A			
(81-91) B			
(69-80) C			
(55-68) D			
(39-54) E			
(21-38) F			
(1-20) G			
Not energy efficient - higher running costs			
		71	80

Agents Note: Whilst every care has been taken to prepare these particulars, they are for guidance purposes only. All measurements are approximate and are for general guidance purposes only and whilst every care has been taken to ensure their accuracy, they should not be relied upon and potential buyers/tenants are advised to recheck the measurements

Hove Lettings
Ground Floor 8 The Drive
Hove
East Sussex
BN3 3JA

01273 917915
hello@nicholasjamesproperty.co.uk
www.nicholasjamesproperty.co.uk

Nicholas
James

SALES LETTINGS AUCTIONS