



FLAT 1, 76 THE DRIVE HOVE, BN3 3PN

£1,900 PER CALENDAR

A superb substantial two double bedroom mansion flat occupying the whole ground floor in this charming period building close to Central Hove.

High ceilings and large windows compliment this apartments large proportions, creating a real sense of space throughout. The impressive lounge diner is definitely a focal point, giving that all important wow factor with its large south facing bay window, ornate cornicing, fire place and very high ceilings. The property further benefits from a mast bedroom with walk in wardrobe, a second double bedroom, modern shower room and kitchen.

**Nicholas
James**
SALES LETTINGS AUCTIONS





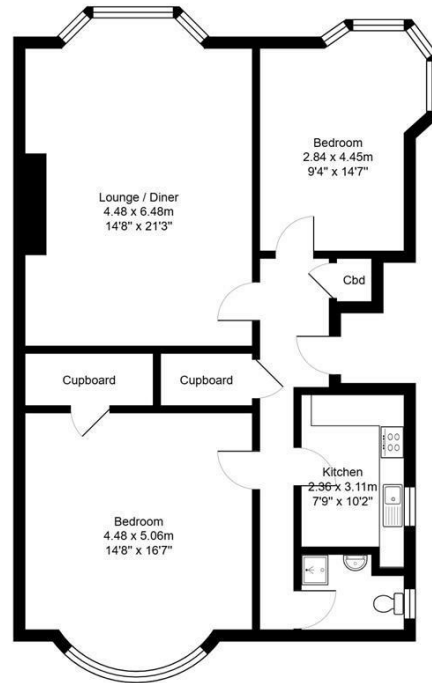

The Drive, Hove, BN3 3PN

Total Area: 90.1 m² ... 970 ft²

All measurements are approximate and for display purposes only.

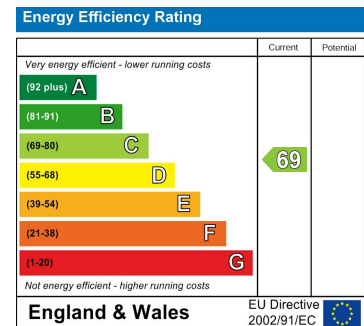

Agents Note: Whilst every care has been taken to prepare these particulars, they are for guidance purposes only. All measurements are approximate and are for general guidance purposes only and whilst every care has been taken to ensure their accuracy, they should not be relied upon and potential buyers/tenants are advised to recheck the measurements

Hove Sales
Ground Floor 8 The Drive
Hove
East Sussex
BN3 3JA

01273 917915
hello@nicholasjamesproperty.co.uk
www.nicholasjamesproperty.co.uk

Nicholas
James

SALES LETTINGS AUCTIONS