



SOUTHDOWN HOUSE 4-8 SOMERHILL AVENUE HOVE, BN3 1RW

£375,000
LEASEHOLD

A bright and spacious first-floor two bedroom apartment (over 800 sq ft) set within a prestigious modern development in the heart of central Hove. Residents benefit from excellent on-site facilities including a private gym, secure underground parking, attractive communal gardens, lift access and a generous communal roof terrace with far reaching views.

The apartment is beautifully presented throughout, benefitting from a bright west-facing aspect and forms part of a recently constructed development offering both comfort and contemporary living in a highly desirable location.

Well positioned for convenience, the property is just a short distance from Brighton and Hove stations, close to highly regarded local schools, within easy reach of the seafront, and moments from the open green spaces of St Ann's Well Gardens.

**Nicholas
James**

SALES LETTINGS AUCTIONS





Southdown House, Hove

Approximate Gross Internal Area = 77.5 sq m / 834 sq ft

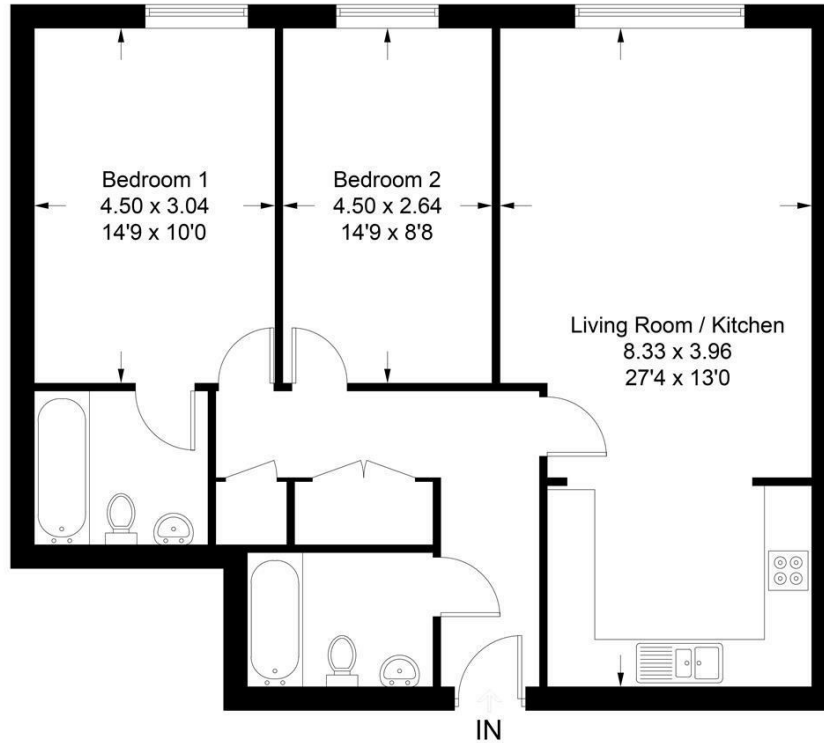

Illustration for identification purposes only, measurements are approximate, not to scale. Fourlabs.co © (ID1292794)



Energy Efficiency Rating		
	Current	Potential
Very energy efficient - lower running costs		
(92 plus) A		
(81-91) B	83	84
(69-80) C		
(55-68) D		
(39-54) E		
(21-38) F		
(1-20) G		
Not energy efficient - higher running costs		
England & Wales	EU Directive 2002/91/EC	

Agents Note: Whilst every care has been taken to prepare these particulars, they are for guidance purposes only. All measurements are approximate and are for general guidance purposes only and whilst every care has been taken to ensure their accuracy, they should not be relied upon and potential buyers/tenants are advised to recheck the measurements

Hove Lettings
Ground Floor 8 The Drive
Hove
East Sussex
BN3 3JA

01273 917915
hello@nicholasjamesproperty.co.uk
www.nicholasjamesproperty.co.uk

**Nicholas
James**

SALES LETTINGS AUCTIONS